

PRODUCT

Snake

DESIGNER

— Franca Lucarelli - Bruna Rapisarda

VERSION



WARMBOOK



p.68

IT	UK	FR	ES	DE
<ul style="list-style-type: none"> - Acciaio - Acciaio inox - Staffe a parete - Valvola di sfogo - Kit copritubo - Valvola e detentore mod. Quadro p.126 - Raccordi 	<ul style="list-style-type: none"> - Steel - Stainless steel - Wall brackets - Exhaust valve - Tube cover kit - Valve/holder Quadro, p.140 - Connection 	<ul style="list-style-type: none"> - Acier - Acier inox - Supports muraux - Soupape de décompression - Kit cache-tube - Vanne et raccord réglable Quadro, p.154 - Raccords 	<ul style="list-style-type: none"> - Acero - Acero inoxidable - Soportes de pared - Purgador - Kit de cobertura tubo - Valvula/llave de cierre Quadro, p.168 - Adaptadores 	<ul style="list-style-type: none"> - Stahl - Inox-Stahl - Wandhalterungen - Entlüftungsventil - Rohrverkleidungssatz - Ventil/Drossel Quadro (ohne thermostatische Regelung), s.182 - Anschlüsse
<ul style="list-style-type: none"> - Acciaio: <ul style="list-style-type: none"> • Colourbook Scirocco H • Ferro grezzo • Cromo • Oro - Acciaio inox: <ul style="list-style-type: none"> • Spazzolato 	<ul style="list-style-type: none"> - Steel: <ul style="list-style-type: none"> • Colourbook Scirocco H • Raw steel • Chrome • Gold - Stainless steel: <ul style="list-style-type: none"> • Brushed 	<ul style="list-style-type: none"> - Acier: <ul style="list-style-type: none"> • Colourbook Scirocco H • Fer brut • Chrome • Or - Acier inox: <ul style="list-style-type: none"> • Brossé 	<ul style="list-style-type: none"> - Acero: <ul style="list-style-type: none"> • Colourbook Scirocco H • Hierro en bruto • Cromo • Oro - Acero inoxidable: <ul style="list-style-type: none"> • Cepillado 	<ul style="list-style-type: none"> - Stahl: <ul style="list-style-type: none"> • Colourbook Scirocco H • Rohstahl • Chrom • Gold - Inox-Stahl: <ul style="list-style-type: none"> • Gebürstet
<ul style="list-style-type: none"> - Fornito con cavo L 150 cm e presa Schuko. Dotato di pulsante ON/OFF - Grado di protezione IP44 - A richiesta disponibile solo con termostato TAVV, p.123 	<ul style="list-style-type: none"> - Furnished with cable L 150 cm and Schuko plug. Equipped with ON/OFF button - Protection rating IP44 - On demand available only with thermostat TAVV, p.137 	<ul style="list-style-type: none"> - Fourni avec câble L 150 cm et prise Schuko. Equipé avec le bouton ON/OFF - Degré de protection IP44 - Sur demande disponible seulement avec thermostat TAVV, p.151 	<ul style="list-style-type: none"> - Se suministra con cable L 150 cm y enchufe Schuko. Equipado con el interruptor ON/OFF - Grado de protección IP44 - Disponible bajo petición con termostato TAVV, p.165 	<ul style="list-style-type: none"> - Komplett mit Kabel L 150 cm und Schuko-Stecker. Mit An/Aus-Schalter - Schutzgrad IP44 - Auf Anfrage verfügbar mit Raumthermostat TAVV, s.179
<ul style="list-style-type: none"> - Attacchi: 3/8" G - Pressione massima d'esercizio: 5 bar - Ogni articolo viene fornito con dima per interasse valvole e posizione fissaggi a muro - Non disponibile per impianti monotubo - Massima temperatura d'esercizio: 90°C 	<ul style="list-style-type: none"> - Connections: 3/8" G - Maximum working pressure: 5 bar - Each item is supplied with a template for the centre distance between the valves and the position for wall fixing - Not available for single tube installation - Maximum working temperature: 90°C 	<ul style="list-style-type: none"> - Connection: 3/8" G - Pression maximale de service: 5 bar - Chaque article est livré avec un gabarit pour entreaxe de soupapes et position de fixations murales - Non disponible pour installations monotube - Température maximum d'exercice: 90°C 	<ul style="list-style-type: none"> - Conexiones: 3/8" G - Presión máxima de trabajo: 5 bar - Todos los artículos se suministran con plantilla para calcular la distancia entre ejes de las válvulas y la posición de los elementos de fijación a la pared - No disponible para instalaciones monotubo - Temperatura máxima de trabajo: 90°C 	<ul style="list-style-type: none"> - Anschlüsse: 3/8" G - Maximaler Betriebsdruck: 5 bar - Jeder Artikel wird mit einer Schablone zur Bestimmung des Ventilabstands und der Wandbefestigungen geliefert - Nicht für Einrohr-Anlagen verfügbar - Maximale betriebstemperatur: 90°C

a

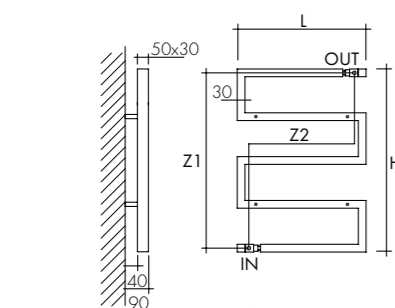
KIT INCASSO
THERMOSTATICO
p.126THERMOSTATIC
KIT
p.140KIT
THERMOSTATIQUE
p.154KIT
THERMOSTATICOS
p.168THERMOSTAT
SATZ
s.182

SNAKE 50

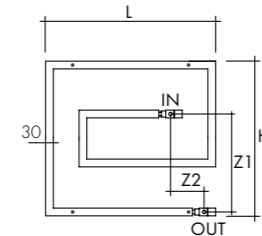

SNAKE 66

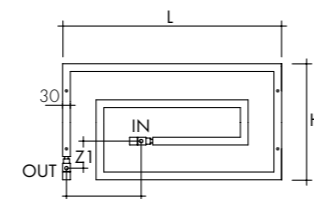

SNAKE 85

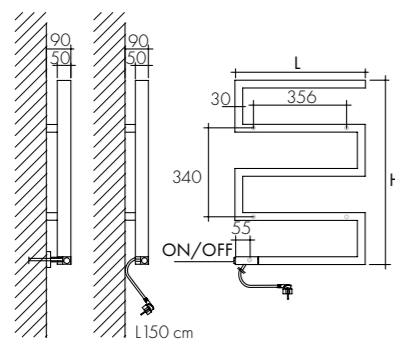

SNAKE 50E

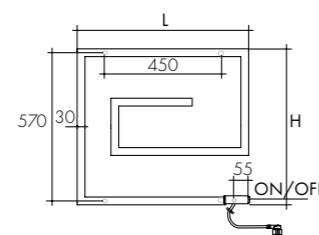

SNAKE 66E

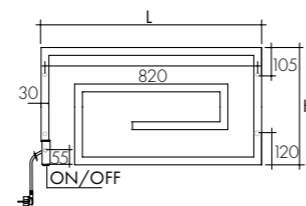

SNAKE 85E

RESE TERMICHE - THERMAL OUTPUT
UNI EN 442 (ΔT 50 K)Watt = Kcal/h ÷ 0,860
Kcal/h = Watt x 0,860IDRAULICO / ELETTRICO
HYDRAULIC / ELECTRIC

ART.	DIMENSIONI DIMENSIONS		RESA OUTPUT	RESA CROMO OUT. CHROME	CAP. CAP.	PESO WEIGHT	RESIST. RESIST.	IDRAULICO / ELETTRICO HYDRAULIC / ELECTRIC						
	L	H	Z1	Z2	W	W	Lt	Kg	Watt	COLORE COLOUR	FERRO GREZZO RAW STEEL	CROMO CHROME	INOX SPAZZ. BRUSHED ST. STEEL	ORO GOLD
SNAKE 50	500	710	680	410	285	230	5,2	6,6	130	€	€	€	€	€
SNAKE 66	660	600	380	130	290	235	5,4	7,1	120	€	€	€	€	€
SNAKE 85	850	450	110	290	305	245	6,2	8,2	132	€	€	€	€	€



WI-FI CONNECTABLE

IT p.122 / UK p.136 / FR p.150 / ES p.164 / DE s.178

Specificare materiale e diametro del tubo di collegamento. Standard multistrato Ø16x2. Please specify in the order material and diameter of the connection pipe. Standard multilayer Ø16x2. Spécifier dans la commande matériel et diamètre du tube de raccordement. Standard couche multiple Ø16x2. Especificar en la orden material y diámetro del tubo de conexión. Standard multicapas Ø16x2. Bei der Bestellung anzugeben material und durchmesser des verbindungsrohrs. Standard mehrschichtverbund Ø16x2.